

TORO

DINGO® COMPACT UTILITY LOADERS



SAVE LABOR, DO MORE AND FINISH FASTER.

Think of all the tasks you have to tackle every day. Now imagine how much faster you could do them with a Toro® Dingo®. Delivering all-day power, jobsite durability and the compact hauling capacity your crew needs, Toro Dingo compact utility loaders are a productivity-boosting alternative to manual labor and other earthmoving equipment — especially in tight, hard-to-reach spots. Patented, customer-favorite traction controls make these machines effortless to operate — no matter your experience level. And now our full lineup offers more choices than ever. Whether you want wheels or tracks, gas, diesel or electric, radial, vertical or telescoping lift arms, or specific attachments, there's a Dingo that's right for you.



HANDLE VIRTUALLY ANY TASK

The Dingo works with a wide range of available attachments. You can do anything from augering, earth moving, tilling and trenching to leveling, lifting, hauling and demolishing with one machine.

Plus, with our full lineup, you can choose from gasoline or diesel models with tracks or wheels to fit the jobs you need to do.

DINGO® SELECTION GUIDE

WHEELED MODELS

	Electric	Gas	Diesel	Ride-On	Radial Lift
 eDingo® 500	X			X	X
Dingo 323		X		X	X
Dingo 320D			X	X	X

TRACKED MODELS

Available in both wide and narrow track

	Gas	Diesel	Ride-On	Radial Lift	Vertical Lift	Telescoping
 Dingo TX 427	X			X		
Dingo TX 525		X		X		
Dingo TX 700		X	X	X		
Dingo TX 1000		X	X		X	
Dingo TX 1300		X	X			X

DINGO® TX 1300 TRACKED MODELS



EXTEND YOUR PROFITABILITY



LONGER REACH, MORE CONTROL.

When you have a lot of material to move, you need the power to do it efficiently. Ideal for landscape, hardscape and tree care jobs, the Toro® Dingo® TX 1300 is the user-friendly workhorse you need to save time. Its combination of power, reach and control puts it in a category of its own, and its jobsite versatility allows you to do more.

TX 1300 CONTROLS

The patented control system is exclusive to the Toro and provides intuitive operation that's effortless for the operator, all day long.

- 1 Grab the traction drive joystick for effortless, single-hand control.
- 2 Curl, dump or float the bucket while raising or lowering the loader arms with one hand using the joystick.
- 3 Activate the auxiliary circuit control switch to power the attachments instantly.



TX 1300 FEATURES



CAPACITY FOR THE JOB

With a 37 hp Yanmar® Tier IV diesel engine and 1,300 lbs. of rated operating capacity, the Dingo TX 1300 is built to save time. It's also compact enough to maneuver in tight spaces larger equipment can't reach.



EXTRA REACH

The exclusive INTELESCOPE® loader arm with SmartLoad gives 26 inches of additional reach. The telescoped hinge-pin height of 109 inches allows loads to be lifted over the sides of dumpsters or trucks to maximize productivity.



FAST CHANGEOUTS

Compatibility with dozens of Toro attachments provides jobsite versatility. Plus, the pressure-relieving quick-coupler connection system makes connecting and disconnecting attachments a breeze.



CONTROL AND ACCESSIBILITY

The hydraulics and loader arm functions are integrated into one thumb-operated controller for easier, more comfortable operation. The stand-on platform design allows for increased mobility and visibility around the machine.

DINGO® TX 1000

TRACKED MODELS



REACH HIGHER & LIFT MORE

THE COMPACT UTILITY LOADER, REDEFINED.

The Toro® Dingo® TX 1000 is a giant step forward in performance and versatility. This lightweight, maneuverable machine packs unmatched strength and reach in a compact package for the ultimate working advantage. The 1,000-plus pounds rated operating capacity makes the TX 1000 a powerful, compact alternative to larger skid-steer loaders and other machines.



TX 1000 CONTROLS

The patented control system is exclusive to Toro and provides intuitive operation that's effortless for the operator, all day long.

- 1 Grab the traction drive joystick for effortless, single-hand control.
- 2 Curl, dump or float the bucket while raising or lowering the loader arms with one hand using the joystick.
- 3 Activate the auxiliary circuit control lever to power the attachments instantly.

TX 1000 FEATURES



UNMATCHED STRENGTH
Vertical lift loader arms allow the TX 1000 to lift and transport heavy loads with a rated operating capacity of 1,000-plus pounds.



MAXIMUM HEIGHT AND REACH
The 81" (206 cm) hinge pin height allows attachments to easily clear the side of 30-yard dumpsters or one-ton trucks.



HIGH DRIVE TRACK SYSTEM
Ideal for the demands of any jobsite to outperform on any surface, even sand or loose gravel.



COMPACT FOOTPRINT
The narrow model is just 33.7" (86 cm) wide and fits through standard 36" gates. At just 41" (104 cm) wide, the wide-track model is also easy to maneuver.

Dingo TX 1000
Narrow Track



Dingo TX 1000 Wide Track

TX 1000

DINGO® TX 700
TRACKED MODELS

TX 700



**POWER COMES
IN COMPACT
PACKAGES**

**THE NO-NONSENSE
WORKHORSE.**

The Toro® Dingo® TX 700 packs a powerful punch in a compact package, making it perfect for projects with limited space. Its all-in-one design, combined with a wide range of compatible attachments, makes it extremely versatile on the job. Moreover, it includes all the familiar features and comforts that you would expect from a Toro Dingo.

Dingo TX 700
Narrow Track



TX 700 CONTROLS

The patented control system is exclusive to Toro and provides intuitive operation that's effortless for the operator, all day long.

- 1** Grab the traction drive joystick for effortless, single-hand control.
- 2** Curl, dump or float the bucket while raising or lowering the loader arms with one hand using the joystick.
- 3** Activate the auxiliary circuit control lever to power the attachments instantly.



Dingo TX 700 Wide Track

TX 700 FEATURES



SMALLER FOOTPRINT

Packs 764 lbs. of rated operating capacity in a smaller footprint, making it ideal for projects where homeowners and contractors need to reach tight areas or work in confined spaces.



EASY OPERATION

Featuring patented traction controls and a dedicated stand-on platform, the Dingo TX 700 is easy to use and offers increased comfort and visibility to the operator.



GENTLE ON TURF

The TX 700 offers versatile track options - a Camso narrow track for enhanced grip or a wide track version that is gentle on the turf. Choose your preferred version based on your terrain and application needs.



JOB VERSATILITY

Compatible with dozens of attachments, including multiple types of buckets, adjustable forks, a grapple, leveler, utility blade and more, the Dingo TX 700 can be used for a wide range of jobs.

DINGO® TX 427 & TX 525 TRACKED MODELS

MORE WORK IN LESS TIME

RUGGED AND DEPENDABLE.

The original tracked compact utility loaders, Toro® Dingo® TX 427 and 525 models deliver durability and reliability pros and do-it-yourselfers trust, combined with powerful performance and incredible versatility. For operators who are frequently switching tasks or moving things out of the way, these walk-behind models provide greater productivity due to the ability to walk up to the machine and go. In addition, with walk-behind Dingos, operators don't feel the bumps when going over rough terrain.



EXCLUSIVE TX CONTROLS

Three simple controls let operators get to work fast:

- 1 Curl, dump or float the bucket while raising or lowering the loader arms with one hand using the joystick.
- 2 Grab the one-handed traction drive from any angle for effortless control.
- 3 Activate the auxiliary circuit control lever to power the attachments instantly.

TX 427 & TX 525 FEATURES



LOW-IMPACT FOOTPRINT

Long-lasting, aramid reinforced tracks disperse weight evenly for a light footprint on turf, while delivering better traction in sandy or wet ground conditions.



HIGH-PERFORMANCE HYDRAULICS

The 4-pump hydraulic system directs power right where you need it. Operate the loader, bucket, traction and auxiliary drives at the same time for increased operator efficiency.



DIESEL AND GAS ENGINES

Choose a gas model for easy maintenance and cold-weather starting. Or choose diesel for better performance in high altitudes and warmer climates, along with more horsepower for attachments.



WALK BEHIND OPERATION

These dedicated walk-behind models allow operators to be separate from the machine for ease-of-use and increased productivity.

Dingo TX 427
Wide Track



Dingo TX 525
Narrow Track

eDINGO® 500
ELECTRIC MODEL



**BRING THE
POWER INDOORS**

**INDOOR SMART,
OUTDOOR TOUGH.**

The eDingo 500 is an ideal choice for indoor construction and demolition, thanks to its electric Hypercell Power System that emits zero emissions. Its slim design allows easy maneuverability through doorways and fits in most elevators. The eDingo is also compatible with popular attachments, showcasing the versatility Toro Dingos are known for. With Toro's patented controls, operation is intuitive and effortless, and it runs efficiently for a full workday on a single charge, ensuring reliable performance.



eDINGO ELECTRIC

eDINGO 500 FEATURES



THE REACH YOU NEED

Industry leading 81" hinge pin height while maintaining 515 lbs. rated operating capacity.

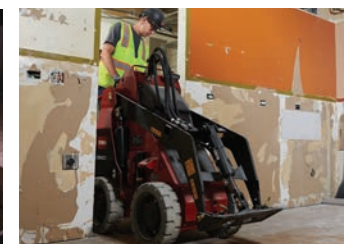

NARROW FOOTPRINT

The next generation eDingo has a brand-new frame with a narrow 30" width footprint to easily fit through a 3-ft. door.



RELIABLE PERFORMANCE

The new eDingo incorporates the Hypercell Power System® with over 13.57 kWh for up to 8 hours of continuous runtime*. *Run time may vary based upon conditions and attachment being used.



PATENTED CONTROLS

With Toro's patented one-handed traction controls, operating the eDingo is easy and user-friendly, providing smooth and precise movements regardless of skill level.

DINGO® 323 & 320D
WHEELED MODELS



BIG BENEFITS IN SMALL SPACES

GO WHERE YOU NEED TO WORK.

Access confined spaces you never thought possible with a wheeled Toro® Dingo® compact utility loader. These models offer zero-turn capability, along with a shorter length that's easy to load on a trailer. You also get reliable hydraulic power to use a wide range of attachments. If you do a lot of tasks in tight spaces or on hard surfaces, these are the models for you.

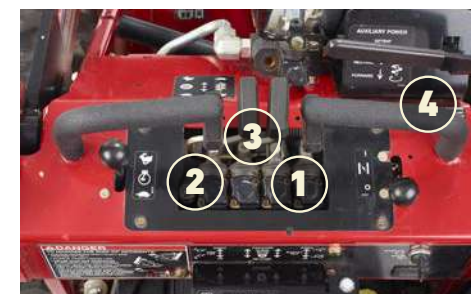

DINGO CONTROLS

Responsive controls make the wheeled Dingo highly maneuverable:

- 1 Curl or dump the attachment while raising or lowering the loader arms.
- 2 Raise and lower loader arms.
- 3 Traction drive control.
- 4 Activate the auxiliary circuit control lever to power the attachments instantly.



Dingo 320-D



Dingo 323

323 & 320D FEATURES



HIGHLY MANEUVERABLE
Short wheelbase design offers excellent maneuverability. Get into tight spaces where only hand labor could go before.



TWO TRANSPORT SPEEDS
Low speed sends more hydraulic power to the attachment and high speed sends more power to the wheels. The low speed option also helps new operators shorten their learning curve.



IMPROVED VISIBILITY
The integrated ride-on operator platform allows improved visibility of the working area and attachments.



4-PAW® INDEPENDENT FOUR-WHEEL DRIVE
Four independent wheel motors deliver hydraulic flow and pressure to all four wheels for improved traction and mobility. Fewer moving parts also mean less maintenance.

TRENCHING, PLOWING AND BORING



BORE DRIVE HEAD
22420

Easily bore under driveways and sidewalks to simplify irrigation and cable installations. Working depth: 19" (48.2 cm). Bits and reamers up to 4.5" (11.4 cm) in diameter available.



VIBRATORY PLOW
22911

Reduce time spent on irrigation or cable installations. The vibratory plow optimizes pipe-pulling performance while minimizing turf damage. Extremely tight turning radius allows for precise maneuvering in confined spaces. A chuted blade for wires is also available.



HIGH-SPEED TRENCHER HEAD
22474

Ideal for fast, efficient trenching in most soil conditions. Great for cable and drainpipe installation, tree planting, irrigation installations and more. Choose from 24", 36" and 48"* (60.9, 91.4, 121.9 cm) booms. *Longer, optional spoils auger recommended for 48" (121.9 cm) boom.



HIGH-TORQUE TRENCHER HEAD
22473

Guarantees performance in difficult soil conditions. Choose from 24", 36" and 48"* (60.9, 91.4, 121.9 cm) booms. *Optional spoils auger recommended for 48" (121.9 cm) boom.



TRENCH FILLER
22472

Fill trenches in a single pass. Two sets of opposing augers direct spoils from the sides of the trench back into the hole. Standard float mechanism allows for up to 5" (12.7 cm) of ground-following flotation. Skids evenly disperse weight and slide easily over turf, minimizing damage. Auger diameter: 14" (35.5 cm)



Bore Drive Head
22420

Rod and Reamer Kit
22421

ROD AND REAMER KIT SPECIFICATIONS | 22421

Standard Equipment	Boring Bit: 1-3/4" Reamer: 2-1/2" Repair Kit: 13/16" Uncoupling Tool: 13/16" Swivel Shank: 13/16" 4 drill rods: 5' length x 7/8" diameter
Weight	57 lbs (26 kg)
Optional Equipment	2" Reamer 2-7/8" Reamer 3-1/4" Reamer 3-1/2" Reamer 4-1/2" Reamer

Vibratory Plow
22911



VIBRATORY PLOW SPECIFICATIONS | 22911

Plow Depths	Adjustable from 6-12" (15.2-30.5 cm) with standard blade or optional heavy-duty 12" (30.5 cm) blade. Adjustable from 12-18" (30.5-45.7 cm) with 18" (45.7 cm) plow blade.
Pipe Size	Up to 1.5" (3.8 cm) diameter flexible polyethylene (with the standard bullet)
Plow Cycle	1,390 vpm at 8.5 gpm (32.2 lpm)
Swing Angle	+/- 30 degrees
Minimum Turning Radius	72" (182.8 cm)
Plow Speed	0 - 88 ft/min. Plow speed varies widely with ground conditions
Width	28.2" (71.6 cm)
Length	34" (86.3 cm)
Height	27" (68.5 cm) without blade 40.2" (102.1 cm) with blade
Weight	457 lbs (207.2 kg)
Mounting Frame	Fabricated, welded steel frame houses a vertical pivot that holds the shaker head, allowing it to follow the traction unit. Compression springs on either side of the head center the head on the pivot.
Isolators	4 x 3.12" (7.9 cm) diameter rubber isolators control the plow vibration amplitude
Bearings	Four pressed-in spherical roller bearings hold the shafts. The bearings are isolated by seals and lubricated by an oil bath. The bearings press into a 3.35" (8.5 cm) bore and fit over a 1.7" (4.3 cm) shaft.
Gear Cover	A machined, cast aluminum cover, with a nitril rubber-coated steel gasket creates a sealed enclosed space for an oil bath to lubricate the gears and bearings.
Blades and Pullers	1/4" x 12" (.63 x 30.4 cm) standard blade 3/8" x 18" (0.9 x 45.7 cm) plow blade 1/2" x 18" (1.2 x 45.7 cm) standard blade 12" (30.4 cm) chuted blade Optional spool carrier for laying cable with chuted blade



TRENCHER HEAD SPECIFICATIONS

	HIGH-SPEED TRENCHER HEAD 22474	HIGH-TORQUE TRENCHER HEAD 22473
Overall Width	35" (88.9 cm)	
Auger Diameter	12.5" (31.7 cm)	
Overall Height	24" (60.9 cm)	
Weight	390 lbs (176.9 kg) with boom and chain	
Torque	442 ft-lbs @ 3,000 psi	675 ft-lbs @ 3,000 psi
Auger Speed	243 rpm @ 14.3 gpm (54.1 lpm)	120 rpm @ 11 gpm (41.6 lpm)

High-Speed
Trencher Head
22474



Trench Filler
22472

TRENCH FILLER SPECIFICATIONS | 22472

Overall Width	62" (157 cm)
Working Width	48" (122 cm)
Overall Length	31" (79 cm)
Overall Height	22" (56 cm)
Weight	410 lbs (186 kg)
Float Distance	5" (12.7 cm)
Auger Diameter	14" (35.6 cm)

BOOMS & CHAINS

Model #	Description
22464	Trencher Crumber
22477	Trencher Crumber
22480	24" x 4" (60.9 x 10.1 cm) Soil Chain
22481	24" x 4" (60.9 x 10.1 cm) Combo Chain
22482	24" x 4" (60.9 x 10.1 cm) Rock Chain
22483	24" x 6" (60.9 x 15.2 cm) Soil Chain
22484	24" x 6" (60.9 x 15.2 cm) Combo Chain
22485	24" x 6" (60.9 x 15.2 cm) Rock Chain
22486	36" x 4" (91.4 x 10.1 cm) Soil Chain
22487	36" x 4" (91.4 x 10.1 cm) Combo Chain
22488	36" x 4" (91.4 x 10.1 cm) Rock Chain
22489	36" x 6" (91.4 x 15.2 cm) Rock Chain
22490	36" x 6" (91.4 x 15.2 cm) Soil Chain
22491	36" x 6" (91.4 x 15.2 cm) Combo Chain
22492	48" x 4" (121.9 x 10.1 cm) Soil Chain
22493	48" x 6" (121.9 x 10.1 cm) Soil Chain
22495	48" x 6" (121.9 x 10.1 cm) Combo Chain
22975	24" (60.9 cm) Boom
22976	36" (91.4 cm) Boom
22977	48" (121.9 cm) Boom



High-Speed Trencher Head
22474

AUGERS AND TREE CARE



HIGH-TORQUE AUGER POWER HEAD
22805

Designed specifically to power up to 30" (76.2 cm) diameter augers in the toughest soil conditions.
Auger bits from 6" to 30" (15.2 x 76.2 cm).



UNIVERSAL SWIVEL AUGER POWER HEAD
22806

Swivels in all directions to ensure plumb holes on uneven terrain up to 18" (45.7 cm). Perfect for installing fences.



STUMP GRINDER
22429

With its rugged design and incredible hydraulic power, the Toro® stump grinder makes powder of the toughest stumps. Grinds down as far as 16.5" below grade. Grinds up to 36" above grade.



REINFORCED ADJUSTABLE FORKS
22586

Manually adjust forks with ease to desired width. Carry fence posts, rocks, pallets, plants, fertilizer, irrigation supplies and more. Forks constructed of high-strength steel. Lift capacity up to 600 lbs* (272.1 kg)
**Dependant upon Dingo model used*



GRAPPLE RAKE
22577

Grab, drag, lift and place materials with ease. The grapple has two heavy-duty cylinders capable of producing 3,000 lbs* (1,361.7 kg) of clamping force at the tine tips, ensuring you can grab hold and not let go. Compact width of 34.5" (87.6 cm) guarantees access to tight areas.
**Dependant upon Dingo model used*



HYDRAULIC TREE FORKS
22438

Plant trees and large shrubs quickly and effortlessly, plus move a variety of other materials around. Consists of two forks with a hydraulic cylinder to pivot one of the forks, creating a clamping action for picking up and moving objects. Angle design allows for gentle handling. Opening at tip: 25" (63.5 cm)

AUGER SPECIFICATIONS

	HIGH TORQUE 22805	UNIVERSAL SWIVEL 22806
Standard Equipment	2-9/16" (6.5 cm) round output shaft for mounting auger bits Dingo Quick-Attach Mounting Plate	
Mounting Frame	Fabricated, welded steel frame with two .75" (1.9 cm) thick pivot ears and a .25" (0.6 cm) thick gusset	
Planetary Mount	Ductile iron, cast planetary mount with clevis-style pivots	
Pivot Pins	Hardened, greaseable, 1" (2.5 cm) diameter flag pins held in place	
Motor Type	LSHT Geroler Motor	
Motor Displacement	11.9 cubic inches (187 cubic cm)/rev	8.0 cubic inches (130 cubic cm)/rev
Motor Rated Pressure	3,000 psi (207 bar) continuous	
Motor Flow Range	0-20 gpm (0-76 lpm)	
Motor Mounting Type	4-Bolt Magneto mounting	
Motor Shaft Type	1.25" (3.1 cm) 14 tooth splined shaft	
Motor Ports	7/8-14 (-10) SAE ORB ports	
Gear Drive Type	Model 6 shaft output Planetary Gear Drive	
Gear Drive Reduction	3.75:1	
Gear Drive Input Mounting Type	4-Bolt Magneto mounting	
Gear Drive Input Shaft Type	1.25" (3.1 cm) 14 tooth splined shaft	
Gear Drive Planetary Mounting	Nine 0.6" (1.5 cm) diameter holes	
Gear Drive Output Shaft	2-9/16" (6.5 cm) diameter output shaft	
Hoses	Two (-8) high-pressure hoses protected by a convoluted tubing cover	
Quick Couplers	Male and female quick flush face couplers	
Dimensions (LxWxH)	24" x 16.5" x 22" (60.9 cm x 41.91 cm x 55.8 cm)	19.3" x 24" x 22" (49.0 cm x 60.9 cm x 55.8 cm)
Weight	215 lbs (97.5 kg)	243 lbs (110.2 kg)
Bit Speed	54 rpm @ 11 gpm (42 lpm), 95% hyd. eff.	80 rpm @ 11 gpm (42 lpm), 95% hyd. eff.
Torque	1,514 ft-lbs (2053 N-m) @ 3,000 psi (207 bar @ 11 gpm (42 lpm))	1,060 ft-lbs (1,437 N-m) @ 3,000 psi (207 bar @ 11 gpm (42 lpm))



AUGER BITS & EXTENSIONS

Model #	Attachment Description
22820	6" (15.2 cm) Full Flight Auger Bit
22821	9" (22.8 cm) Full Flight Auger Bit
22822	12" (30.4 cm) Full Flight Auger Bit
22823	15" (38.1 cm) Full Flight Auger Bit
22814	18" (45.7 cm) Auger Bit
22815	24" (60.9 cm) Auger Bit
22816	30" (76.2 cm) Auger Bit
22818	12" (30.4 cm) Auger Extension
22819	24" (60.9 cm) Auger Extension



STUMP GRINDER SPECIFICATIONS | 22429

Number of Teeth	12 carbide tipped
Wheel Diameter (with Teeth)	49" (124 cm)
Height	16.0" (41 cm)
Weight	170 lbs (77 kg)
Wheel Speed	2,000 rpm
Platform	Fabricated welded frame consisting of .50" (1.3 cm) x 2" (5 cm) steel bars with .63" (1.6 cm) diameter cross bars. Welded to the mounting frame.

Stump Grinder
22429



Hydraulic Tree Forks
22438

HYDRAULIC TREE FORKS SPECIFICATIONS | 22438

Width	24.5" (62.2 cm)
Length	45" (114.3 cm)
Height	12.5" (31.8 cm)
Weight	169 lbs (76.7 kg)
Maximum Lift Height	46" (116.8 cm)
Lift Capacity	335 lbs (152 kg) with 200 lbs (91 kg) operator
Cylinder Force	9,425 lbs (4,275.5 kg) @ 3,000 psi (207 bar)
Fork Length	43" (109.2 cm)
Fork Section	3" (7.6 cm) x 3" (7.6 cm) x .25" (6 mm) thick
Right Fork	Stationary
Left Fork	Pivots 47 degrees plus/minus 1 degree; opens 30" (76.2 cm) wide
Fork Reach (max)	46" (116.8 cm)

GRAPPLE RAKE SPECIFICATIONS | 22521

Overall width	34.5" (86 cm)
Depth*	18" (46 cm)
Overall height	29.5" (74.9 cm)
Grapple opening	33.5" (85.1 cm)
Weight	265 lbs (120 kg)

*When top grapple is fully closed



Grapple Rake
22577



Grapple Rake
22577

EARTHMOVING AND DIGGING



LEVELER
23165

Grade, finish and spread topsoil and other landscape materials. Backfill trenches, break up turf, and carry jobsite materials such as plants, fertilizer, irrigation supplies and more.



SOIL CULTIVATOR
23102

Bury rocks, soil clods, debris and grass. Prepare seed bed in one pass, tilling soil up to 5.5" (13.9 cm) deep. Adjustable grading bar and comb teeth leave perfect germination environment for fresh seed or sod.



TILLER
22445

Hardened steel tines withstand any soil condition, including clay or hardpan. Till up to 6" (15.2 cm) deep and 40" (101.6 cm) wide in one pass. Reversible tine direction frees jams quickly.



POWER BOX RAKE
22426

Perfect tool for seed or sod bed preparation. Carbide-teeth rotary drum pulverizes rough soil, cuts high spots and fills low spots in one pass while removing rocks and debris. Manually adjustable yoke allows 20 degree offset.



BACKHOE WITH 12" BUCKET
23106

Powerful and versatile. Dig foundations, plant trees, trench and much more. Folds to 46.5" (118.1 cm) wide for access to tight spaces and ease of transport.



UTILITY BLADE
22414

Great for filling trenches, pushing snow, grading topsoil, and shaping berms and mounds. Compact size makes it easy to maneuver in confined areas. Hydraulic blade rotates from top to bottom to maximize performance and increase blade life.

LEVELER SPECIFICATIONS | 23165

Length	36" (91.4 cm)
Width	49" (124.4 cm)
Height	16" (40.6 cm)
Weight	170 lbs (77.1 kg)
Platform	Fabricated welded frame consisting of .50" (1.2 cm) x 2" (5.0 cm) steel bars with .63" (1.6 cm) diameter cross bars. Welded to the mounting frame.

Leveler
23165

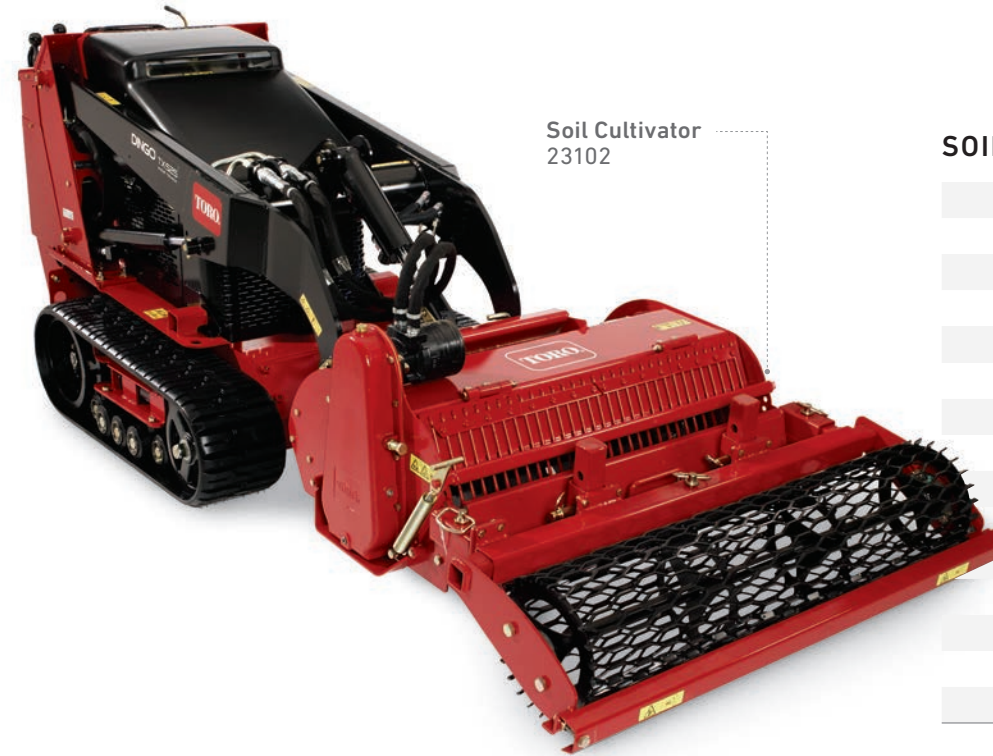
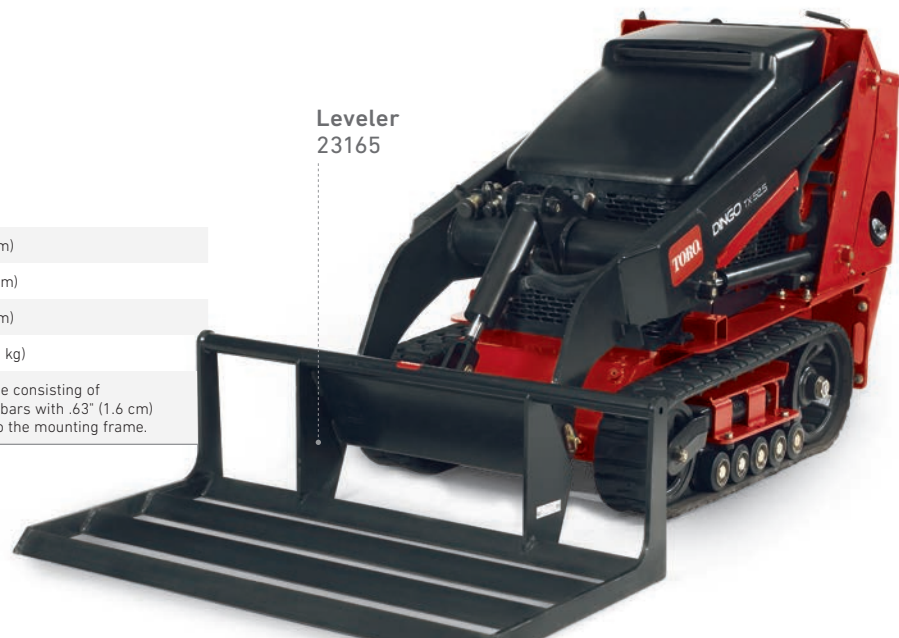

Soil Cultivator
23102

SOIL CULTIVATOR SPECIFICATIONS | 23102

Overall Width	51" (129.5 cm)
Working Width	36" (91.4 cm)
Overall Length	51" (129.5 cm)
Overall Height	21" (53.3 cm)
Working Depth	5.5" (13.9 cm)
Weight	430 lbs (195.0 kg)
Rotor Outside Diameter	15.75" (40.0 cm)
Depth Control	Mechanical adjustment
Grade Blade Adjustment	Screw jack system
Roller Adjustment	Mechanical adjustment
Number of Blades	20 "V" shaped non-panning blades
Number of Grate Fingers	31 screening rods
Motor Type	Powerful LSHT motor
Rated Pressure	206.8 bar
Flow Range	75.7 lpm

TILLER SPECIFICATIONS | 22445

Overall Width	40" (101.6 cm)
Working Width	40" (101.6 cm)
Overall Length	20" (50.8 cm)
Overall Height	26" (66.0 cm)
Working Depth	0 - 6" (0 - 15.2 cm)
Weight	363 lbs (164.6 kg)
Tine Diameter	48.3" (122.6 cm)
No. of Tines	36
Tine Speed	175 rpm @ 8.5 gpm (32.3 lpm)

BUCKET OPTIONS

22340	Dingo TX 1000 Standard Bucket
22342	Dingo TX 1000 High Volume Bucket
22345	Dingo TX 1300 Standard Bucket
22346	Dingo TX 1300 Low Profile Bucket
22409	Standard Bucket
22410	Light Materials Bucket
22478	4-in-1 Bucket
22520	Narrow Bucket
22522	Standard Bucket with Spacer
22590	Grapple Bucket

Tiller
22445





POWER BOX RAKE SPECIFICATIONS | 22426

Overall Width	67" (170.1 cm)
Working Width	48" (121.9 cm)
Overall Length	26" (66.0 cm)
Overall Height	40" (101.6 cm)
Weight	510 lbs (231.3 kg)
Roller Angle	0-20 degrees



Power Box Rake
22426

BACKHOE WITH 12" BUCKET SPECIFICATIONS

Stabilizer Type	Hydraulic, fold-down
Stabilizer Width	78" (198.1 cm)
Transport Width	46.5" (118.1 cm)
Length	41" (104.1 cm)
Height	Transport: 71" (180 cm)
Weight	843 lbs (382.3 kg)
Maximum Digging Depth	82" (208.2 cm)
Swing Arc	180 degrees
Bucket Rotation	180 degrees

*Fit-up kits required to hook up backhoe to Dingo base unit.



Backhoe with
12" (30.4 cm) Bucket
23106



Tiller
22425

UTILITY BLADE SPECIFICATIONS | 22414

Frame	Thick, welded frame assembly
Blade	7 gauge welded blade assembly with two .25" (0.6 cm) thick edges
Grading Width	48" (121.9 cm)
Length	25.25" (64.1 cm)
Height	20.75" (52.7 cm)
Weight	140 lbs (63.5 kg)



Utility Blade
22414

MATERIAL HANDLING



CEMENT BOWL
22442

Mix, haul and pour up to 200 lbs (90.7 kg) of dry cement. Flighting mixes and holds cement in bowl during mixing. The same auger design permits cement to be poured into fence post holes with the posts in place. Auger power head required (*sold separately*).

MULTI-PURPOSE TOOL
22672

Tow, dig and break up soil with the 2-in-1: ripper and towbar.



REINFORCED ADJUSTABLE FORKS
22586

Easily manually adjust forks to desired width. Carry fence posts, rocks, pallets, plants, fertilizer, irrigation supplies and more. Forks constructed of high-strength steel.



HYDRAULIC BREAKER
23136

The perfect tool for precision demolition. Combined with the compact size and ease of use of the Dingo, the breaker simplifies the difficult job of breaking concrete, asphalt, rock or brick during renovation jobs. Powerful performance delivers 250 ft.-lbs. of force and up to 1,150 bpm.



Multi-Purpose
Tool w/hitch
22672

TORO DINGO ATTACHMENTS



CEMENT BOWL SPECIFICATIONS | 22442

Construction	Fabricated, welded steel barrel with 14 gauge walls, 7 and 141 gauge flighting, 10 gauge supports, and a cast 2-9/16" (6.5 cm) diameter receiver tube
Required Equipment	High Torque Auger Power Head (22805) or Universal Swivel Auger Power Head (22806)
Length	18.25" (46.3 cm)
Diameter	25.15" (63.8 cm)
Weight	75 lbs (34.0 kg)
Maximum Dry Concrete Load	200 lbs (90.7 kg)

Cement Bowl
22442

REINFORCED ADJUSTABLE FORKS SPECIFICATIONS | 22586

Width	36" (91.44 cm)
Length	48" (121.9 cm)
Height	30" (101.6 cm)
Weight	244 lbs (110.6 kg)
Lift Capacity	220 lbs (99.7 kg) - excluding TX 1000 and TX 1300 TX 1000: 600 lbs (272.1 kg) TX 1300 (retracted): 900 lbs (408.2 kg) TX 1300 (extended): 500 lbs (226.7 kg)

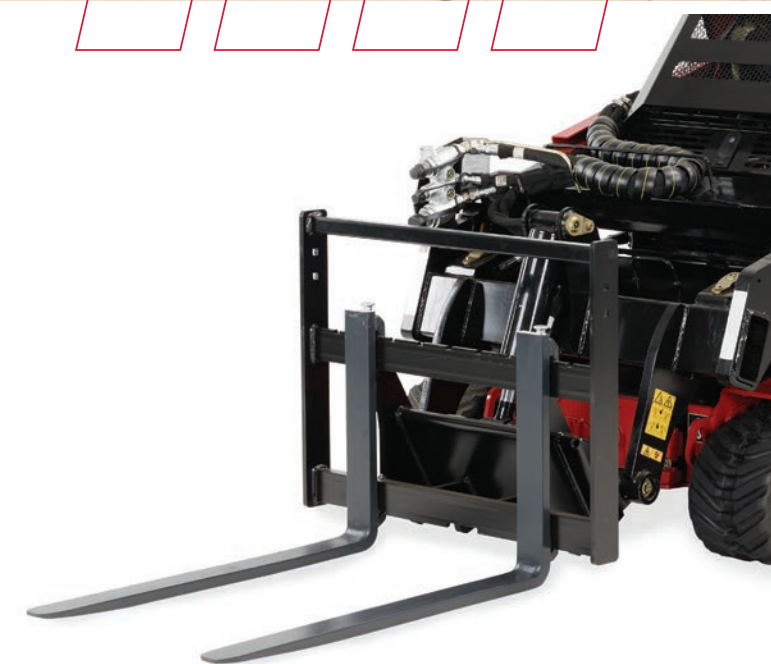



Hydraulic Breaker
23136

HYDRAULIC BREAKER SPECIFICATIONS | 23136

Required Equipment	A crossover relief valve must first be installed on wheeled Dingo models. Installation instructions are included in the kit (99-4360).	
Width	24.8"	(62.9 cm)
Length	51.2"	(130.0 cm)
Height	13"	(33.0 cm)
Weight	389 lbs	(176.4 kg)
Bit Working Length	11.4"	(28.9 cm)
Bit Diameter	2"	(5.0 cm)
Impact Energy Class	250 ft-lbs	(339 J)
Blows Per Minute	600 – 1,150	
Flow Range	5.3 – 8.2 gpm	(20–35 lpm)
Optional Equipment	Line Cut Chisel (106-7667) Asphalt Chisel (106-7684) Tampor Bit (106-7685) Helmet w/Face Shield (100-4143)	

MULTI-PURPOSE TOOL SPECIFICATIONS | 22672

Frame	Fabricated frame assembly consisting of 7 gauge steel bar welded to the Dingo Quick-Attach Mounting Plate. The frame has holes that accept .50" (1.2 cm) clevis pins to hold tools in place	
Ripper Tines	Three fabricated .63" (1.6 cm) thick steel ripper tines with cast ADI spear points connected by spring pins to the tips	
Tow-bar	Fabricated welded .63" (1.6 cm) thick steel tongue, designed to accept a ball with 1" (2.5 cm) diameter threads. Ball not included	
Width	24"	(60.9 cm)
Length	4"	(10.1 cm)
Height	10"	(25.4 cm)
Weight	40 lbs	(18.1 kg)
Recommended Equipment	Counterweight when Boom or Tow-bar is used	

Multi-Purpose Tool
22672



TORO DINGO ATTACHMENTS

DEMOLITION AND CONSTRUCTION



GRAPPLE BUCKET
22590

Designed for contractors looking for a bucket to grab, drag, lift and remove materials on residential, commercial and demolition sites.



4-IN-1 BUCKET
22478

Works as a standard bucket with the jaws completely closed, or a blade or leveler with the jaws completely open. The side jaws can also be used as a grapple to pick up material by closing them over objects or materials to be transported.

GRAPPLE BUCKET SPECIFICATIONS | 22590

Height	21.1" (53.5 cm)
Length	30.8" (78.2 cm)
Width	33.5" (85.0 cm)
Weight	253 lbs (114.7 kg)

4-IN-1 BUCKET SPECIFICATIONS | 22478

Capacity	2.7 cu. ft. (SAE Struck) 3.3 cu. ft. (Heaped)
Height	22" (55.8 cm)
Length	27" (68.5 cm)
Width	49" (124.4 cm)
Weight	292 lbs (132.4 kg)



FLOOR SCRAPER
22670

Displace vinyl, quarry and ceramic tile, carpet squares, paint, glue, asphalt and more. Floating blade holder keeps blades level on uneven ground. Rotating blade holder reduces need to sharpen blade. Three-position arrangement allows user to remove material closer to a wall. Four suitcase weights increase productivity.

FLOOR SCRAPER SPECIFICATIONS | 22670

Required Equipment	A crossover relief valve must first be installed on wheeled Dingo models. Installation instructions are included in the kit (99-4360).	
Height*	16" (40.6 cm)	
Length*	31" (78.7 cm)	
Width*	34" (86.3 cm)	
Weight**	560 lbs (254.0 kg)	

*With blade holder
**Including four weights

SNOW REMOVAL



DINGO TX 1000 SNOW CANOPY
22584

Shields the operator from wind, rain and snow so they can comfortably focus on the task at hand.

SNOW CANOPY SPECIFICATIONS | 22584

Height	90" (229 cm)
Width	39" (99 cm)
Weight	34 lbs (15.4 kg)



DINGO TX 1000 SNOW THROWER
22585

Two-stage design delivers heavy-duty performance in wet snow conditions. Electrical chute articulation can be adjusted from the operator position, no hand-cranking required.

SNOW THROWER SPECIFICATIONS | 22585

Standard Equipment	Quick-Couplers, Mounting Plate
Height	54" (137 cm)
Length	37" (94 cm)
Width	48.5" (123 cm)
Weight	609 lbs (276.2 kg)



BOSS® DINGO SNOW BLADE
STB13567B (5' Snow Blade) STB13759B (4' Snow Blade)

Features polyethylene blade with a reversible plate steel cutting edge. Hydraulic angle allows 30 degree rotation in both directions, no manual adjustments required. Full blade trip design helps to prevent plow or vehicle damage when striking obstacles. *Requires MSC23000 BOSS Dingo Snow Blade Attachment Plate.*

BOSS® DINGO SNOW BLADE SPECIFICATIONS

	5' SNOW BLADE STB13567B	4' SNOW BLADE STB13759B
Height	22" (55.8 cm)	22" (55.8 cm)
Width	52" (132.0 cm) at 30 degree angle	41" (104.1 cm) at 30 degree angle
Weight	190 lb (86.1 kg)	170 lb (77.1 kg)

BOSS ACCESSORIES

Model #	Accessory Description	Model #	Accessory Description	Model #	Accessory Description
MSC04587B	BOSS Snow Deflector Kit	MSC13870B	BOSS Wing Extension Kit	STB13801	BOSS 5' Urethane Edge
MSC13040	BOSS Plow Shoe Kit	MSC23000	BOSS Dingo Snow Blade Attachment Plate (Male Q-tach Plate)	STB13802	BOSS 4' Urethane Edge
MSC13850B	BOSS 6' Blade Extension	MSC13850B	BOSS 6' Blade Extension		

DINGO TX 1300 ATTACHMENTS



GRAPPLE RAKE
22577

Grab, drag, lift and place materials with ease. The grapple has two heavy-duty cylinders capable of producing 3,000 lbs* (1,360.7 kg) of clamping force at the tine tips, ensuring you can grab hold and not let go. Compact width of 34.5" (87.6 cm) guarantees access to tight areas. *Dependant upon Dingo model used



HIGH-SPEED TRENCHER HEAD
22474

Ideal for fast, efficient trenching in most soil conditions. Great for cable and drainpipe installation, tree planting, irrigation installations and more. Choose from 24", 36" and 48"* (60.9, 94.1, 121.9 cm) booms. *Longer optional spoils auger recommended for 48" boom.



BUCKETS

Perfect for light-duty grading, leveling and material handling. Buckets vary in capacity from 4.3 cu. ft. to 9 cu. ft. for lighter materials.



POWER BOX RAKE
22426

Perfect tool for seed or sod bed preparation. Carbide-teeth rotary drum pulverizes rough soil, cuts high spots and fills low spots in one pass while removing rocks and debris. Manually adjustable yoke allows 20 degree offset.



HIGH-TORQUE AUGER POWER HEAD
22805

Designed specifically to power up to 30" (76.2 cm) diameter augers in the toughest soil conditions. Auger bits from 6" to 30" (15.2 to 76.2 cm).



REINFORCED ADJUSTABLE FORKS
22586

Easily manually adjust forks to desired width. Carry fence posts, rocks, pallets, plants, fertilizer, irrigation supplies and more. Forks constructed of high-strength steel. Lift capacity up to 335 lbs* (151.9 kg)

The attachments shown here are compatible with the Dingo TX 1300, which features Toro's exclusive INTELESCOPE® loader arm design.



ATTACHMENTS WITH VERSATILITY IN MIND

Model #	Attachment Description	Model #	Attachment Description
22342	Dingo TX 1000 High-Volume Bucket	22474	High-Speed Trencher Head
22345	Dingo TX 1300 Standard Bucket	22805	High-Torque Auger Power Head
22346	Dingo TX 1300 Low Profile Bucket	22806	Universal Swivel Auger Power Head
22420	Bore Drive Head	22820	6" (15.2 cm) Full Flight Auger Bit
22421	Rod and Reamer Kit	22821	9" (22.8 cm) Full Flight Auger Bit
22672	Multi-Purpose Tool	22822	12" (30.4 cm) Full Flight Auger Bit
22426	Power Box Rake	22823	15" (38.1 cm) Full Flight Auger Bit
22429	Stump Grinder	22814	18" (45.7 cm) Auger Bit
22586	Reinforced Adjustable Forks.	22815	24" (60.9 cm) Auger Bit
22442	Cement Bowl	22816	30" (76.2 cm) Auger Bit
22445	Tiller	22818	12" (30.4 cm) Auger Extension
22464	Trencher Crumber	22819	24" (60.9 cm) Auger Extension
22472	Trench Filler	22577	Grapple Rake
22473	High-Torque Trencher Head	22911	Vibratory Plow

**DINGO
TX 1300**



**DINGO
TX 1000**



**DINGO
TX 700**



		DINGO TX 1300 22370
DIMENSIONS	A Wheelbase	39" (99.0 cm)
	B Ground Clearance	5.9" (14.9 cm)
	Overall Width	46" (116.8 cm) w/bucket
	C Overall Length	103.1" (261.8 cm) w/bucket 84.9" (215.6 cm) w/o bucket
	D Overall Height	56.5" (143.5 cm) w/bucket
	E Max Operating Height	133" (337.8 cm)
	F Hinge Pin Height	109.2" (277.3 cm) extended 89.4" (227.0 cm) retracted
	G Dump Height	90.7" (230.3 cm) extended 70.9" (180.0 cm) retracted
	H Dump Angle	38-degrees
	I Reach – Fully Raised	26.7" (67.8 cm)
MOTOR	Ground Speed (Fwd)	4.7 mph (7.6 km/h)
	Weight	3,858 lbs (1,749.9 kg)
	Tip Capacity	3,714 lbs (1,684.6 kg)
	Rated Operating Capacity (35% of Tip Capacity)*	618 lbs (280.3 kg) extended 1,300 lbs (589.6 kg) retracted
	Engine	37 HP (27 kW) Yanmar® diesel
	Fuel Type	Diesel
	Air Filter	Remote dual element
	Cooling System	Combo downflow radiator and oil cooler, independent fuel cooler
	Fuel Tank	11 gallons (42 liters)
	Oil Capacity	5 quarts (4.7 liters)
OPERATION	Loader Arms	Radial
	Hydraulic Pressure	3,200 PSI (22,063 kPa)
	Hydraulic Flow	Traction: 13.4 gpm (each pump); Auxiliary: 14.3 gpm
	Reservoir Capacity	9.2 gallons (34.8 liters)
	Tracks	MERT track with "TF" style tread
	Traction	Dual hydrostatic pump
	Track Length	126.6" x 9.1" (321.5 cm x 23.1 cm)
	Ground Pressure	5.5 PSI

		DINGO TX 1000 NARROW 22327	DINGO TX 1000 WIDE 22328
A Wheelbase	41" (104.1 cm)		
B Ground Clearance	6.0" (15.2 cm)		
Overall Width	34.2" (86.8 cm)	41" (104.1 cm)	
C Overall Length	100.7" (255.7 cm) w/bucket; 81.7" (207.5 cm) w/o bucket		
D Overall Height	53.2" (135.1 cm)		
E Max Operating Height	105" (266.7 cm)		
F Hinge Pin Height	81" (205.7 cm)		
G Dump Height	61" (154.9 cm)		
H Dump Angle	40 degrees		
I Reach – Fully Raised	24.5" (62.2 cm)		
Ground Speed (Fwd/Rev)	3.7 mph (6.1 km/h)	4.0 mph (7.6 km/h)	
Weight	2,785 lbs (1,263.2 kg)	2,790 lbs (1,265.5 kg)	
Tip Capacity	2,857 lbs (1,295.9 kg)	3,071 lbs (1,392.9 kg)	
Rated Operating Capacity (35% of Tip Capacity)*	1,000 lbs (453.5 kg)	1,075 lbs (487.6 kg)	
Engine	Kubota® D1305		
Manufacturer's Gross HP Rating at RPM**	24.8 HP (18.5 kW) @ 2,600 rpm		
Displacement	77 cu. in. (1262cc)		
Fuel Type	Diesel		
Air Filter	Two-stage, heavy-duty, remote		
Cooling System	Liquid Cooled		
Fuel Tank	11.5 gallons (44 liters)		
Oil Capacity	6.0 quarts (5.7 liters)		
Loader Arms	Vertical		
Hydraulic Pressure	3,000 PSI (20,684 kPa)		
Hydraulic Flow	Traction: 13.3 gpm (each pump); Auxiliary: 15.2 gpm		
Reservoir Capacity	10 gallons (37.85 liters)		
Tracks	Sprocket-drive, 6 road wheels per side		
Traction	Dual hydrostatic pump		
Track Length x Width	127.6" x 5.9" (324.1 cm x 14.9 cm)	127.6" x 9.5" (324.1 cm x 24.1 cm)	
Ground Pressure	5.6 PSI	3.6 PSI	

		DINGO TX 700 NARROW 22351	DINGO TX 700 WIDE 22352
A Wheelbase	39" (99.0 cm)		
B Ground Clearance	5.25" (13.3 cm)		
Overall Width	34.2" (86.9)	40.2" (102.1)	
C Overall Length	102.8" (261.1) w/bucket; 82" (208.3) w/o bucket		
D Overall Height	55.3" (140.5 cm)		
E Max Operating Height	97" (246.4 cm)		
F Hinge Pin Height	73.5" (186.7 cm)		
G Dump Height	52.9" (134.4 cm)		
H Dump Angle	42 degrees		
I Reach – Fully Raised	31" (78.7 cm)		
Ground Speed (Fwd/Rev)	4.5 mph (7.2 km/h)		
Weight	2,514 lbs (1,140.3 kg)	2,602 lbs (1,180.2 kg)	
Tip Capacity	2,182 lbs (989.7 kg)		
Rated Operating Capacity (35% of Tip Capacity)*	764 lbs (346.5 kg)		
Engine	Yanmar 3TNV80F		
Manufacturer's Gross HP Rating at RPM**	24.7 HP (18 kW) @ 3,000 rpm		
Displacement	77 cu. in. (1262cc)		
Fuel Type	Diesel		
Air Filter	Remote single element		
Cooling System	Combo downflow radiator and oil cooler		
Fuel Tank	5.5 gallons (20.8 liters)		
Oil Capacity	3.6 quarts (3.4 liters)		
Loader Arms	Radial		
Hydraulic Pressure	3,000 PSI (20,684 kPa)		
Hydraulic Flow	Traction: 14.5 gpm (each pump) Auxiliary: 13.7 gpm		
Reservoir Capacity	10 gallons (37.9 liters)		
Tracks	Camso B-Tread	Camso Turf Friendly	
Traction	Dual hydrostatic pump		
Track Length x Width	5.4" x 126.6" (13.7 cm x 321.6 cm)	9.1" x 126.6" (23.1 cm x 321.6 cm)	
Ground Pressure	6.4 PSI	4.8 PSI	

* Per ISO 14397-1
** Per SAE 1995

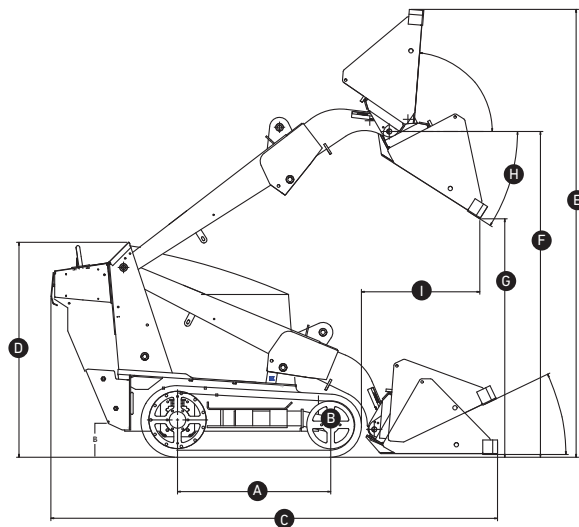

DIMENSIONS

- A** Wheelbase
- B** Ground Clearance
- C** Overall Length
- D** Overall Height
- E** Maximum Operating Height
- F** Hinge Pin Height
- G** Dump Height
- H** Dump Angle
- I** Reach

**DINGO
TX 427
& TX 525**



	TX 525 22323	TX 525 WIDE 22324	TX 427 22321	TX 427 WIDE 22322
A Wheelbase	31.2" (79.2 cm)			
B Ground Clearance	4.6" (11.6 cm)			
Overall Width	33.7" (85.5 cm)	41" (104.1 cm)	33.7" (85.5 cm)	41" (104.1 cm)
C Overall Length	92" (233.6 cm) w/bucket; 70.7" (179.5 cm) w/o bucket			
D Overall Height	46.1" (117.0 cm)			
E Max Operating Height	90.1" (228.8 cm)			
F Hinge Pin Height	65.8" (167.1 cm)			
G Dump Height	46.1" (117.0 cm)			
H Dump Angle	38-degrees			
I Reach - Fully Raised	21.8" (55.3 cm)			
Ground Speed (Fwd/Rev)	Fwd: 0-4.5 mph (0-7.2 km/h) Rev: 0-2.0 mph (0-3.2 km/h)			
Weight	1,904 lbs (863.6 kg)	2,013 lbs (913.0 kg)	1,882 lbs (853.6 kg)	1,990 lbs (902.6 kg)
Tip Capacity	1,580 lbs. (716.6 kg)		1,530 lbs. (693.9 kg)	
Rated Operating Capacity (35% of Tip Capacity)*	553 lbs. (250.8 kg)		535 lbs. (242.6 kg)	
Engine	Kubota D902		Kohler Command Pro Series CH 740	
Manufacturer's Gross HP Rating at RPM**	24.8 HP (18.5 kW) @ 3,200 rpm		25 HP (18.6 kW) @ 3,600 rpm	
Displacement	55 cu. in. (901cc)		44 cu. in. (725cc)	
Fuel Type	Diesel		Gas	
Air Filter	Two-stage, heavy-duty, remote			
Cooling System	Liquid Cooled		Air Cooled	
Fuel Tank	6.0 gallons (23 liters)			
Oil Capacity	3.84 quarts (3.63 liters)		2.0 quarts (2.95 liters)	
Loader Arms	Radial			
Hydraulic Pressure	3,000 PSI (20,684 kPa)			
Hydraulic Flow	Traction: 16.9 gpm (each pump); Auxiliary: 13.8 gpm		Traction: 16.9 gpm (each pump); Auxiliary: 11.4 gpm	
Reservoir Capacity	10.5 gallons (37.8 liters)			
Tracks	Sprocket-drive, 10 road wheels per side			
Traction	Dual hydrostatic pump			
Track Length x Width	96.6" x 5.9" (245.3 cm x 14.9 cm)	96.6" x 9.5" (245.3 cm x 24.1 cm)	96.6" x 5.9" (245.3 cm x 14.9 cm)	96.6" x 9.5" (245.3 cm x 24.1 cm)
Ground Pressure	5.2 PSI	3.4 PSI	5.1 PSI	3.5 PSI

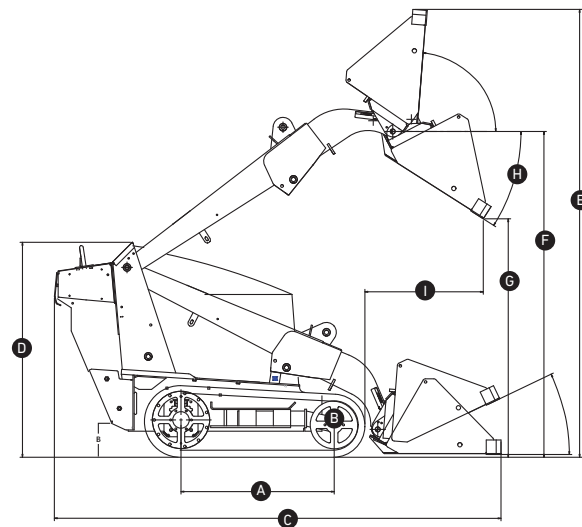

DIMENSIONS

- A** Wheelbase
- B** Ground Clearance
- C** Overall Length
- D** Overall Height
- E** Maximum Operating Height
- F** Hinge Pin Height
- G** Dump Height
- H** Dump Angle
- I** Reach

* Per ISO 14397-1
** Per SAE 1995

eDINGO



**DINGO 323
& 320-D**



	eDingo 22219	DINGO 323 22318	DINGO 320-D 22337CP
A Wheelbase	28" (71.1 cm)	28" (71.1 cm)	
B Ground Clearance	4.25" (10.8 cm)	5.8" (14.7 cm) front & rear	
Overall Width	30" (76.2 cm)	40.5" (102.8 cm) standard tires; 35" (88.9 cm) narrow tires	
C Overall Length	88" (223.5 cm) w/bucket; 66.25" (168.2 cm) w/o bucket	82.2" (208.8 cm) w/bucket; 62" (157.5 cm) w/o bucket	
D Overall Height	54.25" (137.8 cm)	48.7" (123.7 cm)	
E Max Operating Height	106" (269.2 cm)	91.2" (231.6 cm)	
F Hinge Pin Height	81" (205.7 cm)	66" (167.6 cm)	
G Dump Height	61" (154.9 cm)	47" (119 cm)	
H Dump Angle	38 degrees	34 degrees	
I Reach - Fully Raised	21.5" (54.6 cm)	28" (71.1 cm)	
Ground Speed (Fwd/Rev)	2.75 mph (4.43 kph)	0-3.7 mph (0-6 km/h)	0-3.0 mph (0-4.8 km/h)
Weight	2,342 lbs (1,062.3 kg)	1,567 lbs (710.7 kg)	1,722 lbs (781.0 kg)
Tip Capacity	1,251 lbs (567.4 kg)	1,030 lbs (467.2 kg)	1,048 lbs (475.3 kg)
Rated Operating Capacity (35% of Tip Capacity)*	515 lbs (233.6 kg)	515 lbs (233.6 kg)	524 lbs (237.6 kg)
Engine	Lithium Ion	Kohler® Command Series CH23	Kubota D722
Manufacturer's Gross HP Rating at RPM*	15 AMP @ 120V	23 HP (17.2 kW) @ 3,600 rpm	20 HP (14.9 kW) @ 3,600 rpm
Charging Requirements	13.57 kW	41 cu. in. (674cc)	43.88 cu. in. (719 cc)
Capacity	N/A	Gas	Diesel
Fuel Type	N/A	Two-stage, heavy-duty, remote	
Air Filter	N/A	Air Cooled	Liquid Cooled
Cooling System	N/A	11.2 gallon (42.4 liter)	4 gallon (15 liter)
Fuel Tank	N/A	2 quarts (1.9 liter)	3.4 quarts (3.2 liter)
Fuel Tank	N/A	Oil Capacity	
Oil Capacity	N/A	Loader Arms	
Loader Arms	Radial	Radial	
Hydraulic Pressure	3,250 PSI (22,407 kPa)	Hydraulic Pressure	
OPERATION		3,250 PSI (22,407 kPa)	
		Hydraulic Flow	
		10.8 gpm high-flow hydraulic circuit, 4 gpm low-flow hydraulic circuit	
		17 gallons (64 liter)	14.8 gallons (56 liter)
		Reservoir Capacity	

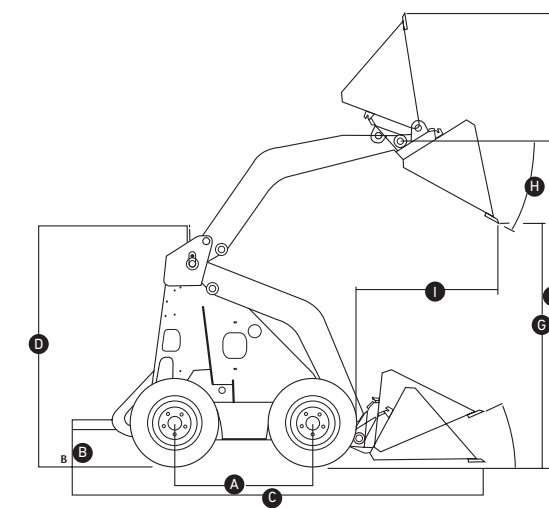

DIMENSIONS

- A** Wheelbase
- B** Ground Clearance
- C** Overall Length
- D** Overall Height
- E** Maximum Operating Height
- F** Hinge Pin Height
- G** Dump Height
- H** Dump Angle
- I** Reach

* Per ISO 14397-1
** Per SAE 1995

THERE IS NO SUBSTITUTE FOR TORO GENUINE PARTS

With Toro, quality and service don't end when you take delivery of your equipment. Genuine Toro parts are designed specifically for your machine to ensure it performs as intended. For peace of mind, insist on Toro genuine parts.



WHEN WE SAY COUNT ON IT, WE MEAN IT

Every product that carries the Toro brand is backed by over 100 years of history, innovation and timeless dependability. We never stop investing in research and development to give our customers the latest features. That's why Toro is one of the best-known, most trusted brands in the business.

We also stand behind our products with a nationwide network of knowledgeable dealers for parts and service support. **Real People. Real Support.**



facebook.com/toro.company



twitter.com/TheToroCompany



instagram.com/thetorocompany



youtube.com/toro



toro.com / toro.ca

490-0898
©2023 The Toro Company, Bloomington, MN 55420
All rights reserved. Printed in the USA.

Products depicted in this literature are for demonstration purposes only. Actual products offered for sale may vary in use, design, required attachments and safety features. We reserve the right to improve our products and make changes in specifications, design and standard equipment without notice and without incurring obligation. See your dealer for details on all our warranties.



Count on it.